

Package Contents

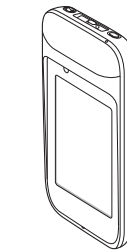

RP350 device



Battery



Battery cover

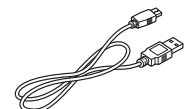

Micro USB cable



The illustrations may differ from your actual items.

Product Overview

Front

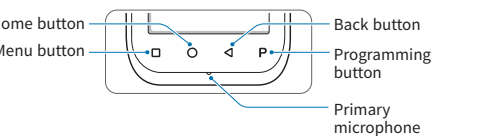
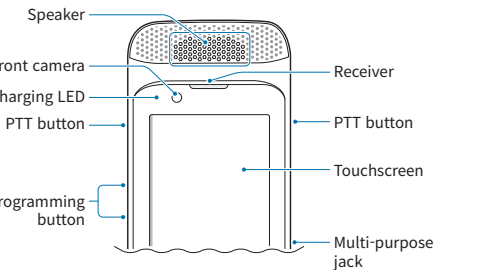

Back

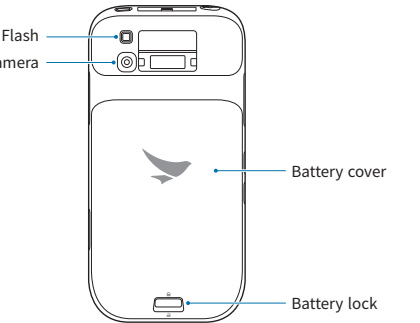

Bottom and Top

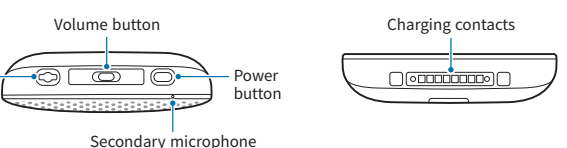

Installing the Battery and Cards

- 1 Slide the battery lock to unlock the battery cover.
- 2 Lift up the battery cover and remove it completely.
- 3 Lift up the bottom of the battery and pull it out of the compartment.
- 4 Insert a micro SIM card into the slot, pressing the lock with a card.
- 5 Insert a micro SD card into the slot, pressing the lock with a card.
- 6 Insert the battery. Make sure the gold contacts are aligned.
- 7 Insert the top of the cover first and then press around the edges of the cover until it clicks into place.
- 8 Close the battery lock to lock the battery cover.

Charging the Battery

- 1 Open the cover of multi-purpose jack.
- 2 Plug the micro 5-pin end of the charger into the device's multi-purpose jack.
- 3 Connect the micro USB cable with power adapter and then plug the charger into a power outlet.

- The charging LED turns red when the battery is charging.
- The charging LED turns green when the battery is fully charged.

You can also charge the device with the optional cradle.

Turning the Device On and Off

Turning the Device On

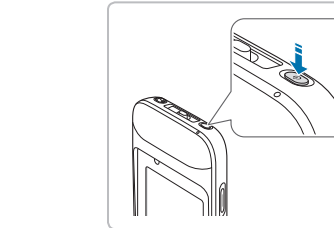

Press and hold the Power button for a few seconds.

Turning the Device Off

- 1 Press and hold the Power button for a few seconds.
- 2 Tap **Power off**.



Registering an account without using Wi-Fi may incur extra charges depending on your data plan.



Do not turn off the device by removing the battery, as this may damage the device.



BLUEBIRD CUSTOMER SERVICE

Operating Hours

Monday to Friday 9:30 A.M. ~ 6:30 P.M.
(GMT Time: +9 Hours)

The center is closed on Saturdays,
Sundays, and Korean national holidays.

Customer Service Center

#1103, Gplus Kolon Digital Tower 11F,
Digital-ro 26-gil 123, Guro-gu, Seoul,
Republic of Korea(08390)

Bluebird constantly strives to bring utmost satisfaction to all our customers.

Using the Touchscreen

Follow the instructions below to correctly use the touchscreen.

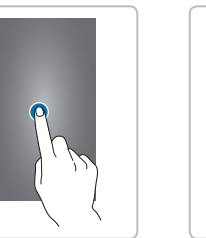

Tap

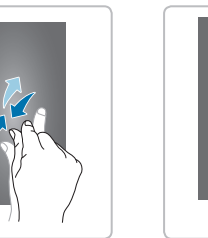

Zoom in or out

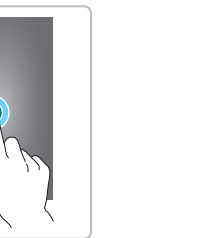

Tap and hold

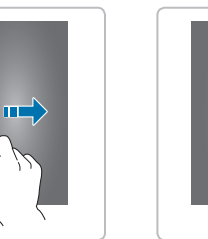

Swipe

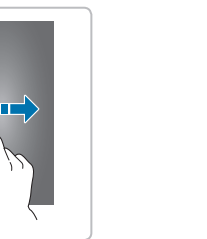

Drag

Using the Home Screen

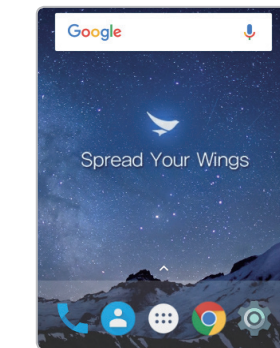

The Home screen is the starting point for all apps and features. It displays icons, shortcuts, and widgets.

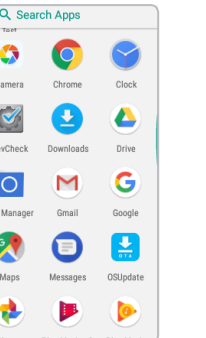

Tap  on the Home screen to access your apps.
Swipe down to search for an app you want to open, or a feature you want to use.



Connecting to a Wi-Fi Network

On the Home screen, tap  >  **Wi-Fi**.
Turn on Wi-Fi and tap the network you want to join.



If necessary, enter the password for the network. If you don't know the password, contact the network administrator.

Connecting via Bluetooth

On the Home screen, tap  >  **Bluetooth**.
Turn on Bluetooth and tap the device name you want to pair.

Accessories

Standard

- Standard battery: 2,860 mAh
- Standard battery cover
- USB cable

Optional

- Cradles
 - 1-slot charging cradle: One charging slot for a handset, one charging slot for a spare battery, one micro USB port
 - 4-slot charging cradle: Four charging slots for handsets, four charging slots for spare batteries, one micro USB port
 - 1-slot Ethernet cradle: One charging slot for a handset, one charging slot for a spare battery, one micro USB port, Ethernet port
 - 4-slot Ethernet cradle: Four charging slots for handsets, four charging slots for spare batteries, one micro USB port, Ethernet port



The power adapter, AC power plug and AC power cable require the use of charging cradles.

- Power adapter for direct charging
- Adapter plug
- Extended battery: 5,720 mAh
- Extended battery cover
- Vehicle charger
- Vehicle mounting cradle
- Beltclip

More Information

Warranty Information

Bluebird Inc. (hereinafter referred to as Bluebird) provides the warranty service for its products in compliance with the Bluebird's warranty program.

Upon receiving a notification on a defect of its product within the range of warranty during the warranty period, Bluebird will repair or replace the defective product according to its warranty policy.

If the defective product within the range of warranty is not repairable or replaceable, Bluebird shall refund the purchasing price within a designated period from the date of receiving a notice of defect.

Bluebird assumes no responsibility for repairing, replacement or refund until it receives the defective product from the customer. The replacement shall be equivalent to a new product in the aspect of performance.

This warranty is applied to software products only when the programming commands are not executed. Bluebird does not guarantee interruption-free or error-free performance.

For more warranty information, see the User Manual.

User Manual

For more details on your device, you can download the user manual from <http://www.bluebirdcorp.com/products/Mobile-Computers/Handheld-Computers/RP350>. The paper version may be available for some regions.

Enterprise Rugged PTT Handheld Computer

RP350

QUICK
GUIDE

BLUEBIRD

